

CPD 17 | STEEL AND OFFSITE CONSTRUCTION

Steel has a key role to play in the government's drive for greater use of offsite construction techniques. This CPD will look at the structural steelwork construction process, with a focus on established offsite processes and practices



An erected steel frame on-site

Introduction

The government and the Construction Leadership Council have earmarked offsite manufacturing as a route to increase construction productivity and reduce costs. A faster on-site construction programme would mean that government construction targets could be met more easily and the programme would be less affected by adverse weather, while a shorter on-site programme is also more cost-effective.

Designers and specifiers have long recognised the benefits that steel offers the construction sector, noting that steel framing is the original offsite framing material.

Fabrication of individual steel pieces takes place

offsite under controlled, highly regulated, safe factory conditions where the use of digital design and leading-edge fabrication systems deliver precision-engineered components with minimum waste. Steel components are further preassembled or fabricated into modules either offsite or at the site at a low level.

Steel structures are often prototyped or trial built offsite to ensure a perfect fit when the fabricated steel modules undergo final assembly on-site. This means that the majority of the value-add for structural steel occurs offsite - in some cases up to 90%.

This CPD will look at the structural steelwork construction process with a focus on established

offsite processes and practices, alongside the benefits provided.

Structural steel procurement

In responding to the tender request, the steelwork contractor gets a price for the rolled steel they need to buy, either directly from the UK mill or from one of the UK's many steel stockholders or distributors. Once the job is secured by the UK steelwork contractor, the steel will be ordered. When the steelwork contractor wins a contract, this is based on a set of "estimate drawings".

On an average contract, the lead time (time before the steel is required on site) may be 10 working weeks. These weeks are for the

»

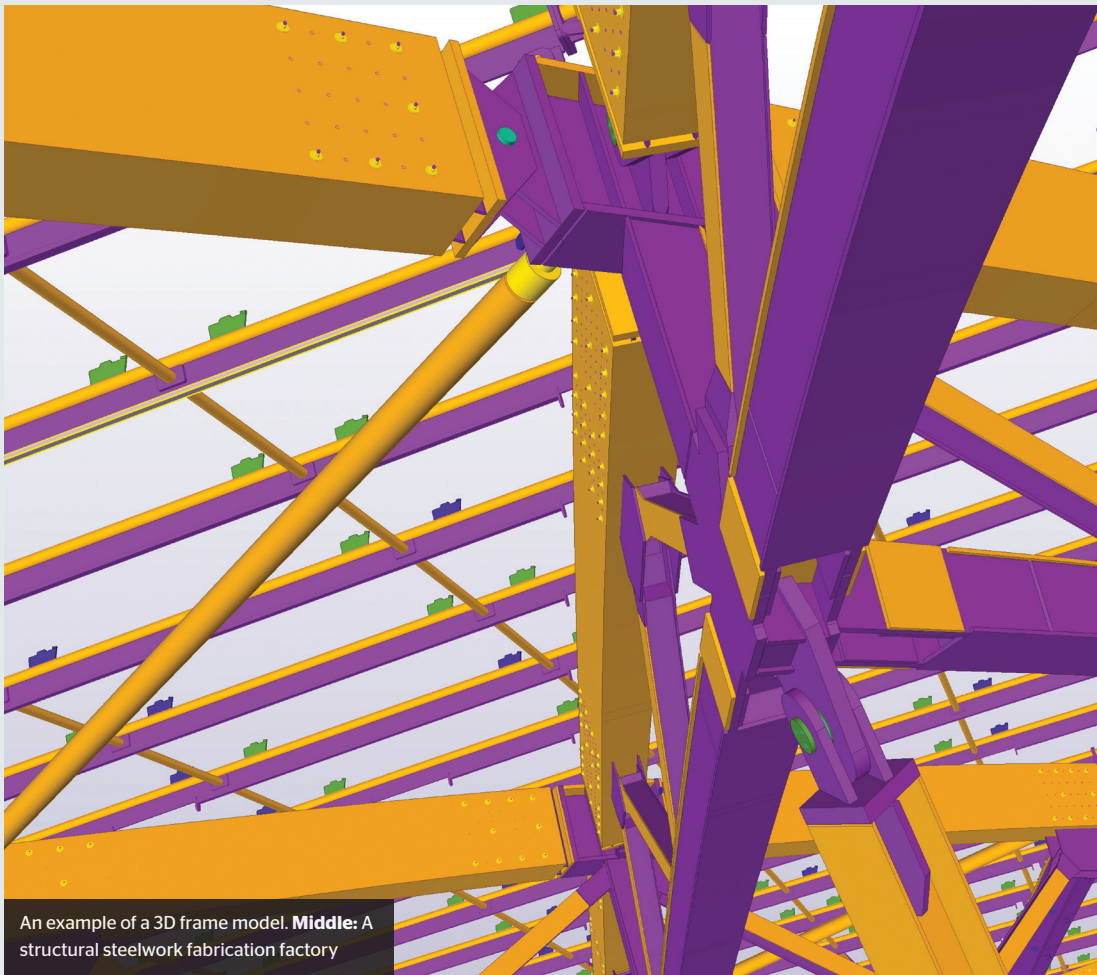

An example of a 3D frame model. **Middle:** A structural steelwork fabrication factory

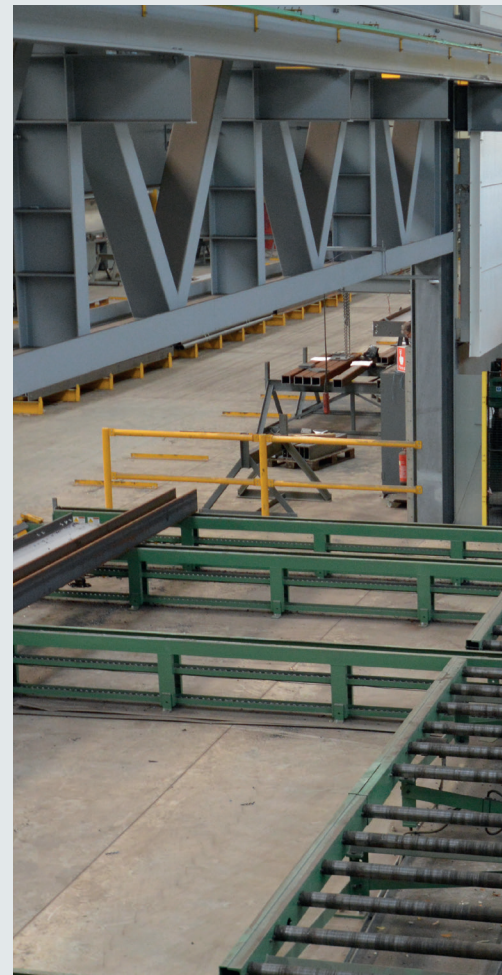

TRIMBLE SOLUTIONS (UK) LTD MIDDLE: PEDDINGHAUS CORPORATION

» steelwork contractor to design the connections, detail the steelwork (drafting the components, working out how the smaller lots go together, etc), issue the drawings/model to the works, order and receive the steel, fabricate the steel and deliver the steel to the construction site.

The client's consulting engineer will normally take the architect's 3D model of the building and provide the structural layout and member sizes. Additional information such as the design forces in the connections may be added for later use by the steelwork contractor. This model is then transposed into structural and detailing information by the steelwork contractor using well-known software packages.

In many building projects, the main contractor will manage a building information management (BIM) system into which all the key parties (and especially the steelwork contractor and other specialist subcontractors) will provide their detailing information to enable the BIM model to be updated and act as a comprehensive source of geometric building data for all of the construction team.

The steelwork contractor will create details of all the connections based on the forces specified by the consulting engineer and may employ their own

consulting engineer for specialist design and temporary works tasks.

Once the job has been confirmed, the steel will typically be procured through the stockholder or distributor route. Orders have to be placed earlier for steel to be bought directly from the mill. If the steel is an unusual grade it might need to be rolled specially or ordered through one of the established routes.

Some products might also need to be purchased through, or fabricated by, specialist suppliers, for example cellular beams (beams with large holes in them to accommodate services), asymmetric beams or plate girders.

Steelwork contractors receive changes to the drawings routinely from the consulting engineer and the main contractor, which they have to deal with as efficiently and as safely as possible. The best way to deal with the changes is by addressing them offsite in the factory before the steel goes to the construction site.

Design

The steel construction sector has been using 3D design software for more than a quarter of a century and is well versed in the benefits and efficiencies it provides to manufacturing and

construction programmes. Today's computer software is integral to the design, fabrication, erection and everyday operational processes at most steelwork contractors' facilities.

Software is interwoven into each stage of the steel fabrication process, supporting activities such as knowledge and bid management, project planning, frame analysis, connection design, 3D modelling, BIM co-ordination and the fabrication process itself.

During the design phase, the structural steel will be modelled to facilitate fabrication. Materials resource planning (MRP) software then processes the bill of materials data from the model, which is used for procurement of materials, manages data to drive automated cutting and fabrication machinery and plans logistics, as well as piece weights for crane planning. MRP software can also be used to monitor progress of fabrication by capturing data about each part as it passes through the different fabrication processes.

The structural steelwork sector is also seeing the adoption of modern scribe marking technologies. Software can allow for full or partial contours to be scribed directly onto the steel to indicate the position of the parts that need to be welded, saving valuable time and minimising errors. In addition, information can be marked on the steel to indicate



Prefabricated structural steel in a factory ready for transportation

JAMESTOWN

quality, traceability, welding information and assembly details.

Fabrication

Once the 3D model and the steel are received in the factory, fabrication will commence. Steelwork fabrication processes include:

- Design and detailing of connections and attachments;
- Cutting to length and chamfering of beams, columns and bracing;
- Drilling of holes for bolts;
- Welding is a core activity in the fabrication factory – it is used to prepare joints for connection on-site and for the attachment of other fixtures and fittings;
- Blast cleaning and painting steelwork;
- Attachment of fitments for installation and protection, eg edge protection;
- Manufacture and attachment of secondary components, such as cleats, shims and bolts and lifting lugs;
- Curving of members, forming of openings – often carried out by specialist companies;
- In some cases, partial concrete encasement and shear connector welding in the factory;
- Scheduling for delivery on a “just-in-time” basis

and transport from the fabrication workshop to the construction site;

- Design of temporary works.

Advances in quality and productivity in the steel construction sector are largely due to developments in fabrication machinery. The manufacturers of steelwork fabrication equipment have invested heavily in research and development to produce the technological advances required by today’s steel construction sector.

Manufacturers of steel fabrication equipment work closely with steelwork contractors planning the factory design and layout with real-time simulation to find the best flow of material and maximise production based on required output through the use of advanced simulation software.

Computer numerically control (CNC) machinery is the standard today and is integrated into each stage of the steel fabrication process. The process may vary between each steelwork contractor but will generally commence with the transfer of 3D model information from the design office to the equipment in the factory.

Benefits of offsite construction

The benefits of offsite construction have long been appreciated by designers, contractors and owners of buildings. Being fabricated offsite in closely

controlled factory conditions means everything is produced to high standards of accuracy and defect free – effectively “right first time”.

Factory-based manufacture allows full integration with the latest computer-aided design and computer-controlled production developments. Digital design for manufacture and assembly, including full BIM Level 2, has additionally created new skills in the sector.

Many processes are fully or at least semi-automated, with industrial robots routinely being used in fabrication factories for operations such as welding. Coatings including intumescent paints can also be applied offsite – indeed the factory application of this type of coating reduces the risk of delay to following trades. It also helps minimise the on-site construction programme.

Offsite manufacture of constructional steelwork results in waste being minimised beyond what can be achieved with alternative materials.

There are other advantages. With on-site work reduced largely to speedy assembly, using structural steelwork means local communities are spared much of the noise and dust inevitably generated by other construction work. Logistical benefits are also derived from steelwork’s ability for timed or just-in-time delivery as dictated by »

» site requirements. The erection of steelwork direct from the just-in-time delivery lorry minimises the requirement for set-down and storage areas, which can be important where space is at a premium.

Additionally, fewer people are required on site, which helps to mitigate issues around skills shortages, and improves on-site safety. The need to work at height is reduced due to the majority of the work taking place offsite, which also provides a skill and safety benefit.

The stable, long-term nature of jobs in a steel fabrication factory assists in the training of a specialist workforce. Such skills development both motivates the workforce and increases the efficiency of offsite steel construction. Offsite steel construction also benefits communities that might not profit directly from investment in construction or infrastructure, for instance some areas outside London and the South, but ongoing manufacturing employment can bring stability and growth to such areas.

Site safety is promoted by offsite production, as manufacture under factory-controlled conditions is inherently safer than is possible under typical construction site conditions. On-site operations are in the hands of highly-qualified site erection teams, who are specialists and are obliged to hold recognised qualifications.

With so much work carried out offsite, the on-site construction programme is reduced and the build programme is relatively unaffected by adverse weather conditions. Steel can be delivered to site as and when it is required, reducing the need for potentially hazardous on-site storage.

Examples of offsite construction incorporating mechanical and electrical services



London Bridge station redevelopment

Already, many steel structures have mechanical and electrical services (M&E) incorporated offsite - some examples include motorway gantries with the lighting and signage already fitted, transfer bridges for large manufacturing plants, and even the risers in high-rise buildings.

Motorways gantries for Highways England

Steelwork contractors receive designs from Highways England that have the M&E incorporated into the BIM model. The steelwork contractor fabricates the gantry offsite, in their factory. The fabricated gantry is then moved to a separate part of the steelwork contractor's manufacturing facility and the M&E contractor

incorporates the electrical/communications cabling and junction boxes on the gantry bodies.

For efficiency, the M&E contractor is only called to the manufacturing facility when a sufficient number of structures have been completed. The steelwork contractor then transports the motorway gantries to site and installs them in approximately 30 minutes, after which the signage and lights are fitted. Pre-installation of electrical/communications cabling and junction boxes on the gantry bodies allows greater control, provides safety benefits and yields both time and cost savings.

London Bridge station redevelopment

Construction of the London Bridge station redevelopment included 1,200 prefabricated steel cassettes installed by Severfield, with each one a bespoke unit due to the changing rooftop geometry. They are 9m long by 3m wide and fabricated from galvanized I-section rafters.

After assembly at Severfield's Bolton and Dalton factories, the project's M&E contractor installed the services and the cladding contractor formed the cassette's individual canopy roof. The completed cassettes were then delivered to site in loads of up to three units per truck and, because they only weighed 2.5 tonnes each, were lifted into place by one of the site's tower cranes.

SEVERFIELD

QUESTIONS

1. Advances in quality and productivity in the steel construction sector are largely due to what?

- Developments in fabrication machinery
- A better educated workforce
- Cheaper steel
- Better on-site communication
- All of the above

2. Up to what percentage of the value-add for structural steel occurs offsite?

- 40%
- 50%
- 60%
- 70%
- 90%

3. When a steelwork contractor wins a contract it will be won based on what?

- Price
- Estimate drawings
- Relationship between client and contractor
- Feasibility study of project
- Location of contractor

4. On an average contract the lead time is how many weeks?

- 5
- 8
- 10
- 12
- 15

5. What is the best way for a steelwork contractor to deal with changes to drawings?

- Address them in the factory before steel is delivered to site
- Assess changes on-site
- Work with consulting engineer and main contractor via email
- Liaise with client to see if changes are absolutely necessary
- Outline new plans and submit to main contractor

To complete this CPD, read the module and then answer the questions online at www.building.co.uk/cpd
Closing date: 12 October 2018
CPD credits: 60 minutes