

TEMPERATURE IN DEGREES CENTIGRADE						
STEEL BEAM						
TIME MINS	LOWER		WEB		UPPER	
	(S)	(N)			(S)	(N)
	603		604		605	606
0.0	*	13	*	13	*	13
0.5	*	13	*	13	*	13
1.0	*	13	*	13	*	13
1.5	*	14	*	14	*	14
2.0	*	14	*	14	*	14
2.5	*	14	*	14	*	14
3.0	*	14	*	14	*	14
3.5	*	14	*	14	*	15
4.0	*	15	*	18	*	19
4.5	*	19	*	23	*	27
5.0	*	23	*	29	*	32
5.5	*	28	*	32	*	39
6.0	*	33	*	38	*	43
6.5	*	38	*	43	*	48
7.0	*	42	*	47	*	52
7.5	*	48	*	53	*	59
8.0	*	54	*	59	*	64
8.5	*	61	*	66	*	70
9.0	*	67	*	71	*	75
9.5	*	75	*	79	*	79
10.0	*	84	*	88	*	83
10.5	*	93	*	93	*	84
11.0	*	105	*	107	*	94
11.5	*	119	*	120	*	105
12.0	*	134	*	131	*	111
12.5	*	149	*	146	*	122
13.0	*	170	*	167	*	150
13.5	*	187	*	179	*	162
14.0	*	202	*	191	*	173
14.5	*	221	*	209	*	189
15.0	*	240	*	224	*	200
15.5	*	258	*	236	*	212
16.0	*	271	*	244	*	214
16.5	*	283	*	250	*	221
17.0	*	297	*	261	*	230
17.5	*	308	*	269	*	237
18.0	*	318	*	275	*	240
18.5	*	324	*	276	*	241
19.0	*	332	*	284	*	251
19.5	*	343	*	294	*	263
20.0	*	350	*	297	*	265
20.5	*	355	*	300	*	266
21.0	*	364	*	308	*	272
21.5	*	375	*	319	*	281
22.0	*	388	*	332	*	291
22.5	*	399	*	338	*	290
23.0	*	404	*	338	*	286
23.5	*	407	*	339	*	286
24.0	*	410	*	340	*	286
24.5	*	411	*	339	*	288
25.0	*	417	*	348	*	291
25.5	*	420	*	347	*	293
26.0	*	421	*	348	*	293
26.5	*	423	*	350	*	294
27.0	*	424	*	350	*	295
27.5	*	426	*	352	*	297
28.0	*	427	*	352	*	299
28.5	*	427	*	353	*	299
29.0	*	428	*	354	*	300
29.5	*	430	*	354	*	303
30.0	*	430	*	356	*	303
30.5	*	432	*	358	*	305
31.0	*	433	*	359	*	306
31.5	*	434	*	361	*	308
32.0	*	436	*	363	*	310

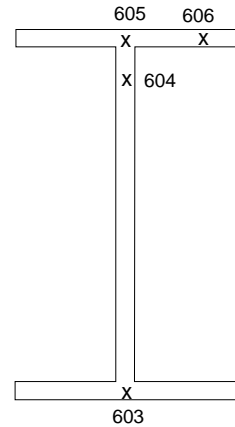

* Not Measured
| Not Recorded

Steel Temperatures On Secondary Beam At SB5E

Table 20.1

32.5	*	439	*	*	*	365	*	*	*	306	313	*
33.0	*	442	*	*	*	369	*	*	*	309	315	*
33.5	*	445	*	*	*	370	*	*	*	310	317	*
34.0	*	446	*	*	*	373	*	*	*	312	317	*
34.5	*	449	*	*	*	376	*	*	*	315	319	*
35.0	*	450	*	*	*	377	*	*	*	318	321	*
35.5	*	453	*	*	*	379	*	*	*	320	324	*
36.0	*	455	*	*	*	382	*	*	*	322	325	*
36.5	*	457	*	*	*	384	*	*	*	324	328	*
37.0	*	459	*	*	*	384	*	*	*	326	331	*
37.5	*	459	*	*	*	386	*	*	*	327	332	*
38.0	*	459	*	*	*	387	*	*	*	329	333	*
38.5	*	459	*	*	*	388	*	*	*	330	333	*
39.0	*	459	*	*	*	389	*	*	*	332	336	*
39.5	*	459	*	*	*	389	*	*	*	333	338	*
40.0	*	460	*	*	*	390	*	*	*	333	339	*
40.5	*	459	*	*	*	391	*	*	*	336	339	*
41.0	*	460	*	*	*	393	*	*	*	336	340	*
41.5	*	461	*	*	*	394	*	*	*	338	341	*
42.0	*	462	*	*	*	395	*	*	*	339	345	*
42.5	*	462	*	*	*	397	*	*	*	341	344	*
43.0	*	462	*	*	*	396	*	*	*	341	347	*
43.5	*	463	*	*	*	397	*	*	*	342	347	*
44.0	*	462	*	*	*	398	*	*	*	345	348	*
44.5	*	463	*	*	*	399	*	*	*	345	350	*
45.0	*	463	*	*	*	400	*	*	*	346	350	*
45.5	*	463	*	*	*	401	*	*	*	347	351	*
46.0	*	463	*	*	*	401	*	*	*	348	354	*
46.5	*	463	*	*	*	402	*	*	*	350	354	*
47.0	*	464	*	*	*	403	*	*	*	350	355	*
47.5	*	464	*	*	*	404	*	*	*	352	356	*
48.0	*	465	*	*	*	406	*	*	*	354	357	*
48.5	*	465	*	*	*	407	*	*	*	354	358	*
49.0	*	466	*	*	*	408	*	*	*	356	360	*
49.5	*	467	*	*	*	410	*	*	*	357	361	*
50.0	*	468	*	*	*	411	*	*	*	359	364	*
50.5	*	469	*	*	*	413	*	*	*	360	365	*
51.0	*	470	*	*	*	415	*	*	*	361	365	*
51.5	*	470	*	*	*	416	*	*	*	363	369	*
52.0	*	471	*	*	*	416	*	*	*	364	372	*
52.5	*	472	*	*	*	417	*	*	*	366	373	*
53.0	*	472	*	*	*	419	*	*	*	366	375	*
53.5	*	474	*	*	*	420	*	*	*	367	378	*
54.0	*	475	*	*	*	422	*	*	*	370	381	*
54.5	*	477	*	*	*	424	*	*	*	372	383	*
55.0	*	478	*	*	*	427	*	*	*	373	387	*
55.5	*	481	*	*	*	429	*	*	*	376	391	*
56.0	*	484	*	*	*	433	*	*	*	377	394	*
56.5	*	487	*	*	*	435	*	*	*	379	397	*
57.0	*	490	*	*	*	438	*	*	*	381	400	*
57.5	*	494	*	*	*	441	*	*	*	384	405	*
58.0	*	498	*	*	*	445	*	*	*	388	407	*
58.5	*	503	*	*	*	450	*	*	*	391	412	*
59.0	*	508	*	*	*	454	*	*	*	393	416	*
59.5	*	512	*	*	*	458	*	*	*	397	418	*
60.0	*	516	*	*	*	461	*	*	*	401	422	*
60.5	*	520	*	*	*	465	*	*	*	403	426	*
61.0	*	524	*	*	*	469	*	*	*	406	429	*
61.5	*	528	*	*	*	471	*	*	*	409	432	*
62.0	*	532	*	*	*	475	*	*	*	412	435	*
62.5	*	535	*	*	*	478	*	*	*	416	437	*
63.0	*	538	*	*	*	481	*	*	*	419	439	*
63.5	*	542	*	*	*	487	*	*	*	423	443	*
64.0	*	547	*	*	*	493	*	*	*	428	450	*
64.5	*	551	*	*	*	497	*	*	*	432	453	*
65.0	*	556	*	*	*	500	*	*	*	435	459	*
65.5	*	557	*	*	*	500	*	*	*	438	458	*
66.0	*	557	*	*	*	497	*	*	*	439	460	*
66.5	*	556	*	*	*	498	*	*	*	440	459	*
67.0	*	557	*	*	*	498	*	*	*	441	460	*

Steel Temperatures On Secondary Beam At SB5E

Table 20.1

67.5	*	556	*	*	*	498	*	*	*	443	462	*
68.0	*	556	*	*	*	498	*	*	*	444	463	*
68.5	*	556	*	*	*	499	*	*	*	445	464	*
69.0	*	556	*	*	*	499	*	*	*	447	467	*
69.5	*	558	*	*	*	502	*	*	*	448	469	*
70.0	*	557	*	*	*	502	*	*	*	450	469	*
70.5	*	557	*	*	*	501	*	*	*	449	467	*
71.0	*	555	*	*	*	500	*	*	*	451	467	*
71.5	*	553	*	*	*	498	*	*	*	450	468	*
72.0	*	552	*	*	*	498	*	*	*	450	468	*
72.5	*	551	*	*	*	497	*	*	*	451	469	*
73.0	*	550	*	*	*	499	*	*	*	451	468	*
73.5	*	550	*	*	*	498	*	*	*	452	469	*
74.0	*	549	*	*	*	498	*	*	*	453	469	*
74.5	*	548	*	*	*	497	*	*	*	453	470	*
75.0	*	548	*	*	*	498	*	*	*	453	470	*
75.5	*	548	*	*	*	499	*	*	*	454	471	*
76.0	*	548	*	*	*	499	*	*	*	454	472	*
76.5	*	548	*	*	*	500	*	*	*	455	471	*
77.0	*	549	*	*	*	502	*	*	*	457	473	*
77.5	*	550	*	*	*	504	*	*	*	457	473	*
78.0	*	552	*	*	*	505	*	*	*	459	476	*
78.5	*	553	*	*	*	506	*	*	*	460	475	*
79.0	*	553	*	*	*	506	*	*	*	460	474	*
79.5	*	552	*	*	*	507	*	*	*	461	474	*
80.0	*	553	*	*	*	508	*	*	*	462	477	*
80.5	*	555	*	*	*	509	*	*	*	463	479	*
81.0	*	555	*	*	*	510	*	*	*	465	478	*
81.5	*	556	*	*	*	511	*	*	*	465	481	*
82.0	*	556	*	*	*	512	*	*	*	466	480	*
82.5	*	557	*	*	*	513	*	*	*	467	482	*
83.0	*	558	*	*	*	514	*	*	*	469	483	*
83.5	*	559	*	*	*	515	*	*	*	470	484	*
84.0	*	560	*	*	*	516	*	*	*	471	486	*
84.5	*	562	*	*	*	519	*	*	*	472	487	*
85.0	*	563	*	*	*	520	*	*	*	474	491	*
85.5	*	564	*	*	*	522	*	*	*	475	491	*
86.0	*	566	*	*	*	523	*	*	*	476	493	*
86.5	*	566	*	*	*	523	*	*	*	478	494	*
87.0	*	567	*	*	*	524	*	*	*	478	495	*
87.5	*	568	*	*	*	524	*	*	*	479	495	*
88.0	*	568	*	*	*	524	*	*	*	480	495	*
88.5	*	568	*	*	*	525	*	*	*	481	495	*
89.0	*	568	*	*	*	525	*	*	*	482	496	*
89.5	*	567	*	*	*	526	*	*	*	482	495	*
90.0	*	567	*	*	*	525	*	*	*	483	495	*
90.5	*	567	*	*	*	526	*	*	*	484	494	*
91.0	*	566	*	*	*	526	*	*	*	484	494	*
91.5	*	566	*	*	*	525	*	*	*	485	494	*
92.0	*	565	*	*	*	526	*	*	*	485	495	*
92.5	*	565	*	*	*	526	*	*	*	485	494	*
93.0	*	565	*	*	*	526	*	*	*	486	494	*
93.5	*	565	*	*	*	526	*	*	*	486	496	*
94.0	*	565	*	*	*	527	*	*	*	486	496	*
94.5	*	566	*	*	*	528	*	*	*	488	498	*
95.0	*	567	*	*	*	529	*	*	*	488	498	*
95.5	*	568	*	*	*	531	*	*	*	489	499	*
96.0	*	569	*	*	*	532	*	*	*	491	499	*
96.5	*	570	*	*	*	533	*	*	*	491	500	*
97.0	*	571	*	*	*	535	*	*	*	493	501	*
97.5	*	573	*	*	*	536	*	*	*	493	503	*
98.0	*	575	*	*	*	538	*	*	*	495	502	*
98.5	*	576	*	*	*	539	*	*	*	496	504	*
99.0	*	578	*	*	*	541	*	*	*	497	505	*
99.5	*	580	*	*	*	542	*	*	*	499	507	*
100.0	*	582	*	*	*	544	*	*	*	500	508	*
100.5	*	583	*	*	*	546	*	*	*	502	509	*
101.0	*	585	*	*	*	548	*	*	*	504	511	*
101.5	*	587	*	*	*	553	*	*	*	507	512	*
102.0	*	590	*	*	*	556	*	*	*	510	513	*

Steel Temperatures On Secondary Beam At SB5E

Table 20.1

102.5	*	593	*	*	*	560	*	*	*	511	517	*
103.0	*	596	*	*	*	563	*	*	*	515	518	*
103.5	*	599	*	*	*	567	*	*	*	518	520	*
104.0	*	602	*	*	*	570	*	*	*	520	522	*
104.5	*	604	*	*	*	573	*	*	*	523	524	*
105.0	*	608	*	*	*	577	*	*	*	526	527	*
105.5	*	611	*	*	*	579	*	*	*	528	530	*
106.0	*	615	*	*	*	585	*	*	*	532	532	*
106.5	*	620	*	*	*	590	*	*	*	535	536	*
107.0	*	629	*	*	*	599	*	*	*	541	543	*
107.5	*	641	*	*	*	610	*	*	*	549	549	*
108.0	*	652	*	*	*	622	*	*	*	556	556	*
108.5	*	663	*	*	*	631	*	*	*	563	563	*
109.0	*	673	*	*	*	640	*	*	*	569	569	*
109.5	*	682	*	*	*	645	*	*	*	575	575	*
110.0	*	683	*	*	*	642	*	*	*	579	580	*
110.5	*	683	*	*	*	642	*	*	*	582	586	*
111.0	*	685	*	*	*	645	*	*	*	586	592	*
111.5	*	691	*	*	*	653	*	*	*	591	604	*
112.0	*	701	*	*	*	668	*	*	*	599	615	*
112.5	*	709	*	*	*	675	*	*	*	605	623	*
113.0	*	716	*	*	*	681	*	*	*	612	630	*
113.5	*	720	*	*	*	685	*	*	*	616	638	*
114.0	*	722	*	*	*	689	*	*	*	621	644	*
114.5	*	724	*	*	*	692	*	*	*	626	651	*
115.0	*	726	*	*	*	696	*	*	*	630	655	*
115.5	*	728	*	*	*	700	*	*	*	634	660	*
116.0	*	731	*	*	*	703	*	*	*	638	663	*
116.5	*	735	*	*	*	705	*	*	*	641	668	*
117.0	*	738	*	*	*	707	*	*	*	645	671	*
117.5	*	741	*	*	*	710	*	*	*	648	673	*
118.0	*	744	*	*	*	712	*	*	*	651	678	*
118.5	*	748	*	*	*	715	*	*	*	655	678	*
119.0	*	753	*	*	*	719	*	*	*	658	678	*
119.5	*	757	*	*	*	721	*	*	*	661	680	*
120.0	*	762	*	*	*	724	*	*	*	665	682	*
120.5	*	767	*	*	*	726	*	*	*	669	686	*
121.0	*	773	*	*	*	731	*	*	*	672	687	*
121.5	*	777	*	*	*	734	*	*	*	676	691	*
122.0	*	780	*	*	*	739	*	*	*	680	693	*
122.5	*	785	*	*	*	743	*	*	*	682	696	*
123.0	*	790	*	*	*	747	*	*	*	686	700	*
123.5	*	788	*	*	*	746	*	*	*	688	699	*
124.0	*	783	*	*	*	744	*	*	*	689	698	*
124.5	*	779	*	*	*	741	*	*	*	689	699	*
125.0	*	775	*	*	*	740	*	*	*	689	698	*
125.5	*	771	*	*	*	739	*	*	*	690	699	*
126.0	*	769	*	*	*	739	*	*	*	690	697	*
126.5	*	767	*	*	*	738	*	*	*	690	697	*
127.0	*	765	*	*	*	737	*	*	*	691	697	*
127.5	*	763	*	*	*	737	*	*	*	691	697	*
128.0	*	762	*	*	*	737	*	*	*	691	696	*
128.5	*	760	*	*	*	735	*	*	*	692	697	*
129.0	*	759	*	*	*	735	*	*	*	692	697	*
129.5	*	759	*	*	*	735	*	*	*	691	697	*
130.0	*	758	*	*	*	735	*	*	*	692	696	*
130.5	*	757	*	*	*	735	*	*	*	692	697	*
131.0	*	756	*	*	*	733	*	*	*	692	696	*
131.5	*	754	*	*	*	731	*	*	*	691	695	*
132.0	*	753	*	*	*	729	*	*	*	690	695	*
132.5	*	751	*	*	*	727	*	*	*	689	696	*
133.0	*	749	*	*	*	725	*	*	*	690	694	*
133.5	*	748	*	*	*	724	*	*	*	689	693	*
134.0	*	746	*	*	*	722	*	*	*	687	694	*
134.5	*	745	*	*	*	720	*	*	*	687	694	*
135.0	*	743	*	*	*	719	*	*	*	686	692	*
135.5	*	741	*	*	*	717	*	*	*	684	691	*
136.0	*	739	*	*	*	716	*	*	*	684	692	*
136.5	*	738	*	*	*	715	*	*	*	682	690	*
137.0	*	737	*	*	*	715	*	*	*	682	690	*

Steel Temperatures On Secondary Beam At SB5E

Table 20.1

137.5	*	737	*	*	*	716	*	*	*	683	690	*
138.0	*	737	*	*	*	718	*	*	*	683	690	*
138.5	*	738	*	*	*	718	*	*	*	683	691	*
139.0	*	739	*	*	*	720	*	*	*	683	689	*
139.5	*	739	*	*	*	720	*	*	*	684	689	*
140.0	*	739	*	*	*	720	*	*	*	683	690	*
140.5	*	740	*	*	*	722	*	*	*	684	690	*
141.0	*	739	*	*	*	721	*	*	*	685	690	*
141.5	*	740	*	*	*	722	*	*	*	685	690	*
142.0	*	741	*	*	*	723	*	*	*	685	690	*
142.5	*	745	*	*	*	727	*	*	*	688	697	*
143.0	*	751	*	*	*	734	*	*	*	690	700	*
143.5	*	756	*	*	*	736	*	*	*	692	704	*
144.0	*	758	*	*	*	736	*	*	*	694	704	*
144.5	*	760	*	*	*	739	*	*	*	696	705	*
145.0	*	761	*	*	*	739	*	*	*	697	705	*
145.5	*	761	*	*	*	737	*	*	*	696	705	*
146.0	*	761	*	*	*	739	*	*	*	698	707	*
146.5	*	765	*	*	*	743	*	*	*	699	711	*
147.0	*	768	*	*	*	745	*	*	*	702	715	*
147.5	*	772	*	*	*	748	*	*	*	704	719	*
148.0	*	774	*	*	*	749	*	*	*	706	721	*
148.5	*	778	*	*	*	752	*	*	*	707	723	*
149.0	*	779	*	*	*	754	*	*	*	709	725	*
149.5	*	780	*	*	*	754	*	*	*	711	728	*
150.0	*	781	*	*	*	755	*	*	*	711	727	*
150.5	*	781	*	*	*	755	*	*	*	712	728	*
151.0	*	781	*	*	*	755	*	*	*	712	728	*
151.5	*	780	*	*	*	755	*	*	*	713	729	*
152.0	*	779	*	*	*	753	*	*	*	714	727	*
152.5	*	774	*	*	*	747	*	*	*	711	726	*
153.0	*	765	*	*	*	739	*	*	*	708	720	*
153.5	*	754	*	*	*	729	*	*	*	703	715	*
154.0	*	743	*	*	*	718	*	*	*	699	710	*
154.5	*	732	*	*	*	707	*	*	*	694	705	*
155.0	*	723	*	*	*	699	*	*	*	688	699	*
155.5	*	716	*	*	*	691	*	*	*	682	693	*
156.0	*	709	*	*	*	684	*	*	*	677	686	*
156.5	*	702	*	*	*	677	*	*	*	672	681	*
157.0	*	694	*	*	*	670	*	*	*	667	675	*
157.5	*	686	*	*	*	664	*	*	*	662	671	*
158.0	*	678	*	*	*	657	*	*	*	657	667	*
158.5	*	670	*	*	*	655	*	*	*	652	662	*
159.0	*	661	*	*	*	653	*	*	*	647	656	*
159.5	*	654	*	*	*	650	*	*	*	643	651	*
160.0	*	647	*	*	*	645	*	*	*	639	645	*
160.5	*	647	*	*	*	638	*	*	*	634	640	*
161.0	*	646	*	*	*	631	*	*	*	629	633	*
161.5	*	642	*	*	*	623	*	*	*	624	628	*
162.0	*	635	*	*	*	616	*	*	*	619	622	*
162.5	*	626	*	*	*	608	*	*	*	614	618	*
163.0	*	617	*	*	*	601	*	*	*	608	612	*
163.5	*	608	*	*	*	595	*	*	*	603	606	*
164.0	*	599	*	*	*	589	*	*	*	597	600	*
164.5	*	591	*	*	*	582	*	*	*	591	594	*
165.0	*	583	*	*	*	575	*	*	*	587	591	*
165.5	*	575	*	*	*	570	*	*	*	580	584	*
166.0	*	568	*	*	*	563	*	*	*	575	579	*
166.5	*	561	*	*	*	558	*	*	*	570	574	*
167.0	*	554	*	*	*	553	*	*	*	564	568	*
167.5	*	547	*	*	*	546	*	*	*	560	563	*
168.0	*	541	*	*	*	541	*	*	*	554	558	*
168.5	*	535	*	*	*	536	*	*	*	549	553	*
169.0	*	529	*	*	*	532	*	*	*	544	547	*
169.5	*	523	*	*	*	527	*	*	*	539	542	*
170.0	*	518	*	*	*	521	*	*	*	534	539	*
170.5	*	512	*	*	*	517	*	*	*	530	532	*
171.0	*	507	*	*	*	511	*	*	*	525	529	*
171.5	*	501	*	*	*	507	*	*	*	521	524	*
172.0	*	496	*	*	*	503	*	*	*	516	519	*

Steel Temperatures On Secondary Beam At SB5E

Table 20.1

172.5	*	491	*	*	*	497	*	*	*	512	515	*
173.0	*	487	*	*	*	493	*	*	*	507	510	*
173.5	*	482	*	*	*	489	*	*	*	503	507	*
174.0	*	477	*	*	*	485	*	*	*	498	503	*
174.5	*	473	*	*	*	481	*	*	*	495	497	*
175.0	*	468	*	*	*	476	*	*	*	490	494	*
175.5	*	464	*	*	*	472	*	*	*	487	490	*
176.0	*	460	*	*	*	469	*	*	*	483	486	*
176.5	*	456	*	*	*	465	*	*	*	480	482	*
177.0	*	451	*	*	*	461	*	*	*	476	478	*
177.5	*	448	*	*	*	457	*	*	*	471	475	*
178.0	*	443	*	*	*	453	*	*	*	468	472	*
178.5	*	440	*	*	*	451	*	*	*	464	467	*
179.0	*	436	*	*	*	446	*	*	*	461	465	*
179.5	*	432	*	*	*	443	*	*	*	458	460	*
180.0	*	428	*	*	*	440	*	*	*	456	456	*
180.5	*	425	*	*	*	437	*	*	*	451	453	*
186.5	*	390	*	*	*	405	*	*	*	421	421	*
196.5	*	337	*	*	*	354	*	*	*	369	371	*
206.5	*	297	*	*	*	316	*	*	*	330	330	*
216.5	*	265	*	*	*	285	*	*	*	299	300	*
226.5	*	243	*	*	*	262	*	*	*	275	276	*
236.5	*	212	*	*	*	235	*	*	*	250	249	*
246.5	*	185	*	*	*	212	*	*	*	227	226	*
256.5	*	165	*	*	*	192	*	*	*	208	209	*
266.5	*	149	*	*	*	178	*	*	*	193	191	*
276.5	*	137	*	*	*	166	*	*	*	179	178	*
286.5	*	126	*	*	*	153	*	*	*	168	168	*
296.5	*	117	*	*	*	145	*	*	*	158	156	*
306.5	*	110	*	*	*	135	*	*	*	148	148	*
316.5	*	102	*	*	*	127	*	*	*	140	137	*
326.5	*	95	*	*	*	120	*	*	*	132	130	*
336.5	*	90	*	*	*	113	*	*	*	125	124	*
346.5	*	86	*	*	*	108	*	*	*	118	116	*
356.5	*	81	*	*	*	103	*	*	*	113	112	*
366.5	*	77	*	*	*	98	*	*	*	108	106	*
376.5	*	74	*	*	*	94	*	*	*	103	102	*
386.5	*	71	*	*	*	91	*	*	*	99	97	*
396.5	*	68	*	*	*	87	*	*	*	95	93	*
406.5	*	65	*	*	*	83	*	*	*	91	91	*
416.5	*	63	*	*	*	81	*	*	*	87	86	*
426.5	*	61	*	*	*	77	*	*	*	85	85	*
436.5	*	59	*	*	*	74	*	*	*	82	81	*
446.5	*	57	*	*	*	73	*	*	*	79	77	*
456.5	*	56	*	*	*	70	*	*	*	76	76	*
466.5	*	54	*	*	*	68	*	*	*	73	73	*
476.5	*	52	*	*	*	66	*	*	*	71	70	*
486.5	*	51	*	*	*	63	*	*	*	68	69	*
496.5	*	50	*	*	*	62	*	*	*	66	66	*
506.5	*	48	*	*	*	61	*	*	*	65	64	*
516.5	*	47	*	*	*	58	*	*	*	64	62	*
526.5	*	45	*	*	*	56	*	*	*	62	62	*
536.5	*	45	*	*	*	56	*	*	*	59	58	*
546.5	*	44	*	*	*	55	*	*	*	58	56	*
556.5	*	42	*	*	*	53	*	*	*	57	55	*
566.5	*	41	*	*	*	51	*	*	*	56	53	*
576.5	*	41	*	*	*	50	*	*	*	53	54	*
586.5	*	39	*	*	*	49	*	*	*	52	51	*
596.5	*		*	*	*		*	*	*			*
606.5	*		*	*	*		*	*	*			*
616.5	*		*	*	*		*	*	*			*
626.5	*		*	*	*		*	*	*			*
636.5	*		*	*	*		*	*	*			*
646.5	*		*	*	*		*	*	*			*
656.5	*		*	*	*		*	*	*			*
666.5	*		*	*	*		*	*	*			*
676.5	*		*	*	*		*	*	*			*
686.5	*		*	*	*		*	*	*			*
696.5	*		*	*	*		*	*	*			*
706.5	*		*	*	*		*	*	*			*

Steel Temperatures On Secondary Beam At SB5E

Table 20.1

716.5	*		*	*	*		*	*	*			*	
726.5	*		*	*	*		*	*	*			*	
736.5	*		*	*	*		*	*	*			*	
746.5	*		*	*	*		*	*	*			*	
756.5	*		*	*	*		*	*	*			*	
766.5	*		*	*	*		*	*	*			*	
776.5	*		*	*	*		*	*	*			*	
786.5	*		*	*	*		*	*	*			*	
796.5	*		*	*	*		*	*	*			*	
806.5	*		*	*	*		*	*	*			*	
816.5	*		*	*	*		*	*	*			*	
826.5	*		*	*	*		*	*	*			*	
836.5	*		*	*	*		*	*	*			*	
846.5	*		*	*	*		*	*	*			*	
856.5	*		*	*	*		*	*	*			*	
866.5	*		*	*	*		*	*	*			*	
876.5	*		*	*	*		*	*	*			*	
886.5	*		*	*	*		*	*	*			*	
896.5	*		*	*	*		*	*	*			*	
906.5	*		*	*	*		*	*	*			*	
916.5	*		*	*	*		*	*	*			*	
926.5	*		*	*	*		*	*	*			*	
936.5	*		*	*	*		*	*	*			*	
946.5	*		*	*	*		*	*	*			*	
956.5	*		*	*	*		*	*	*			*	
966.5	*		*	*	*		*	*	*			*	
976.5	*		*	*	*		*	*	*			*	
986.5	*		*	*	*		*	*	*			*	
996.5	*		*	*	*		*	*	*			*	
1006.5	*		*	*	*		*	*	*			*	
1016.5	*		*	*	*		*	*	*			*	
1026.5	*		*	*	*		*	*	*			*	
1036.5	*		*	*	*		*	*	*			*	
1046.5	*		*	*	*		*	*	*			*	
1056.5	*		*	*	*		*	*	*			*	
1066.5	*		*	*	*		*	*	*			*	
1076.5	*		*	*	*		*	*	*			*	
1086.5	*		*	*	*		*	*	*			*	
1096.5	*		21	*	*		21	*	*		21	21	*

606
X

4